

BEAM ANGLE	APPLICATION	SPECIFICATION	DIMMABLE
	Facade Lighting Indoor Wall Wash		



Input Voltage
DC24V

General / Others Specification

Items	Specification
Driven Method	DC24V (Constant Voltage)
Beam Angle	30°
CRI	Ra > 80
LED Colour Bin	3 Steps MacAdam
Environment	Indoor / Outdoor (IP65)**1
Expected LED Life Span	L ₇₀ = 50,000hrs @ 25°C
Operation Temp. / Hum.	-25°C ~ 50°C / 20% ~ 85% RH
Storage Temp.	-25°C ~ 60°C

**1 Not Suitable for use under direct Sun application

Order / Model Code

GT6
PRODUCT NAME

Length options: 03 : 1 ft, 06 : 2 ft, 09 : 3 ft, 12 : 4 ft

CCT options: 65 : 6500K, 50 : 5000K, 40 : 4000K, 30 : 3000K

H CRI : > 80

3 BEAM ANGLE : 30°

X LED VERSION

Basic Specifications (Unit:mm)

Glow Tube VI Length (1146 / 861 / 576 / 291)

Brown Cable (+) 24V
Blue Cable (-) GND

Product Mode: GT612-65H3_X
DC24V - 33.60W 6500K (P00A00)

Colour Temperature 65 → 6500K
Manufacturing Series Number
Power Consumption
Driving Mode Constant Voltage DC24V
Product Length: 12 → L = 1146mm, 09 → L = 861mm, 06 → L = 576mm, 03 → L = 291mm

Specification (@25°C)

Models	CCT	Lumen (lm)	CRI (Ra)	Beam Angle (°)	LEDs Quantity (pcs)	Input Voltage (V)	Rated Power (W)	Size (Diameter x L) (mm)	Average Weight (g)
GT603-65H3_B	6500K	480	> 80	30	6	24	8.40	∅30 x 291	167
GT603-50H3_B	5000K	480							
GT603-40H3_B	4000K	470							
GT603-30H3_B	3000K	440							
GT606-65H3_B	6500K	960	> 80	30	12	24	16.80	∅30 x 576	320
GT606-50H3_B	5000K	960							
GT606-40H3_B	4000K	940							
GT606-30H3_B	3000K	880							
GT609-65H3_B	6500K	1440	> 80	30	18	24	25.20	∅30 x 861	485
GT609-50H3_B	5000K	1440							
GT609-40H3_B	4000K	1410							
GT609-30H3_B	3000K	1320							
GT612-65H3_B	6500K	1920	> 80	30	24	24	33.60	∅30 x 1146	650
GT612-50H3_B	5000K	1920							
GT612-40H3_B	4000K	1880							
GT612-30H3_B	3000K	1760							

** Wire gauge : AWG18 x 2 core

Specification may be subject to change without announcement. Data is only for reference.

www.aristo.com.sg, Tel: (65) 64792358, Fax: (65) 65793558

Rev.A (Mar-22)

■ **Design Item**

View : Top

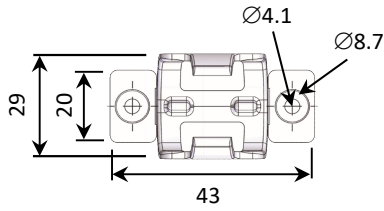

View : Side

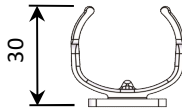

View : Side

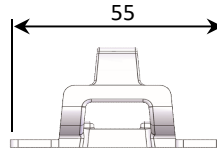

View : Side (angle adjustable)

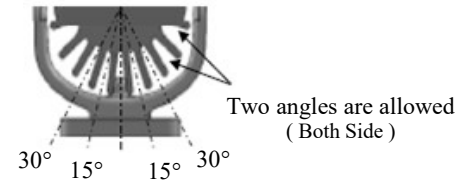

Stainless Steel Bracket (Outdoor)

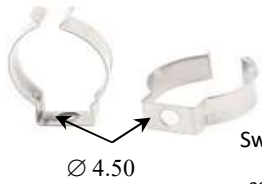

Swivel dimension
(L x H x W)
22.00 x 32.00 x 7.00

Type of connector

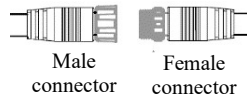

● **Type of Wire Outlet**

● **Standard : Both ends with Wire Harness**



● **Option 1 : One end with Wire Harness**

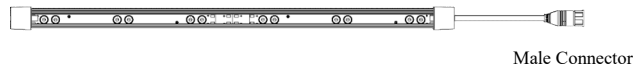

● **Option 2 : Both ends with Bare Wire**



● **Option 3 : One end with Bare Wire**



@ Power supply unit load

Length	Power Supply 100W DC24V (pcs)	Power Supply 150W DC24V (pcs)
1 ft	9	14
2 ft	4	7
3 ft	3	4
4 ft	2	3

Terminator end-cap or heat shrink tube with gel type to make the end wire waterproof level condition



■ **Wiring Method**

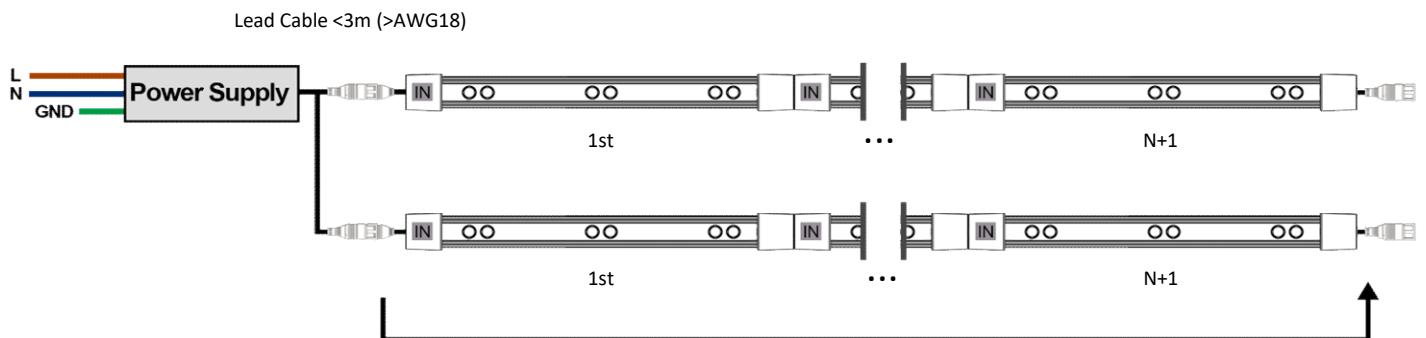

The maximum number of series connection is 4ft 3pcs

** Maximum current in one series connection is less than 4A